

PSRC's Project Selection Process and Draft 2025–2028 Transportation Improvement Program

Regional Staff Committee
September 19, 2024



Puget Sound Regional Council



We are leaders in the region to realize equity for all. Diversity, racial equity and inclusion are integrated into how we carry out all our work.

psrc.org/equity

Presentation Overview

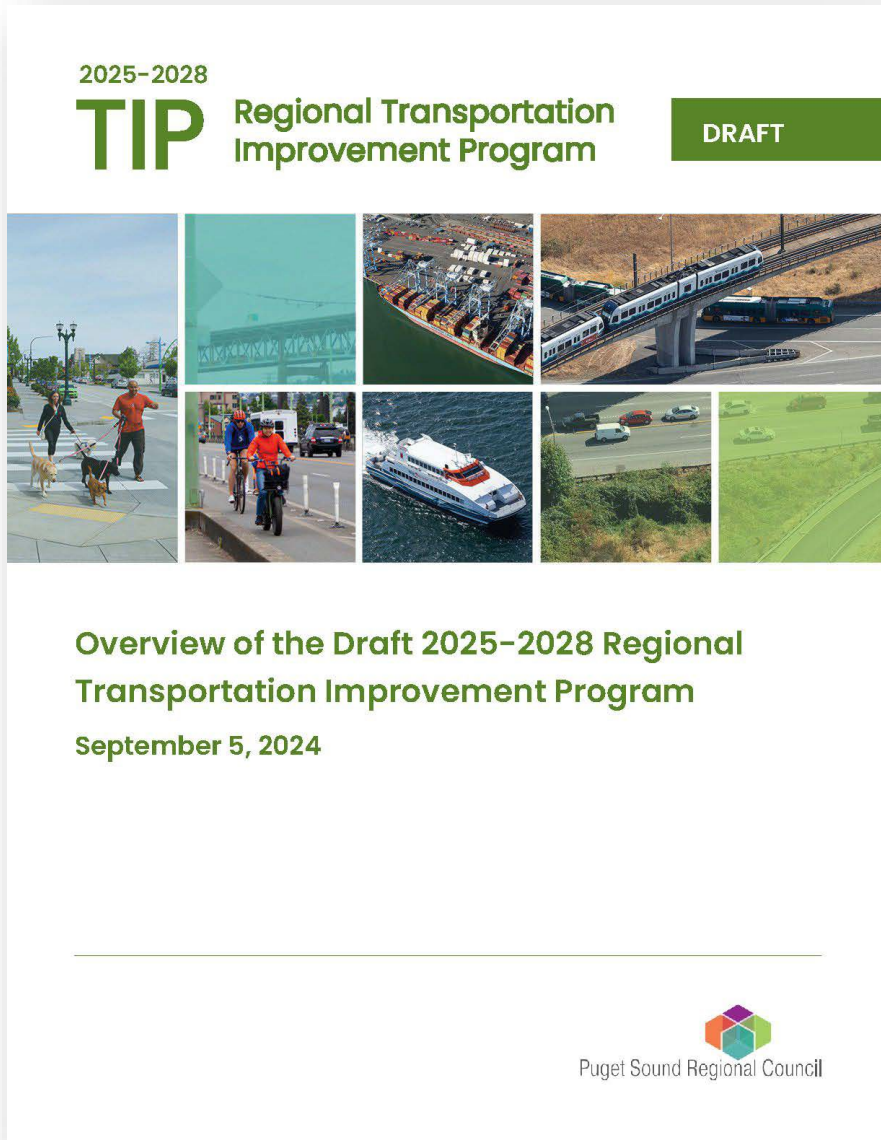

- Overview of the Draft 2025-2028 Regional Transportation Improvement Program (TIP)
- Project Highlights
- Schedule
- PSRC's 2024 Project Selection Process – Key Updates and Outcomes



Draft 2025–2028 Regional TIP



PSRC requirement under federal and state law

Projects originate from state / local planning processes

Are reviewed vigorously for consistency with regional policies, state and federal requirements

Draft 2025–2028 TIP includes 136 projects awarded PSRC federal funds from the 2024 project selection process



Draft 2025–2028 Regional TIP

- Four-year snapshot in time
- Includes 435 projects with:
 - PSRC's federal funds
 - Other federal transportation funds
 - State and local funds in regionally significant projects
- **\$9.6 billion** total funding programmed
- Represents **~\$44 billion** in total project investments
- Includes detailed project information

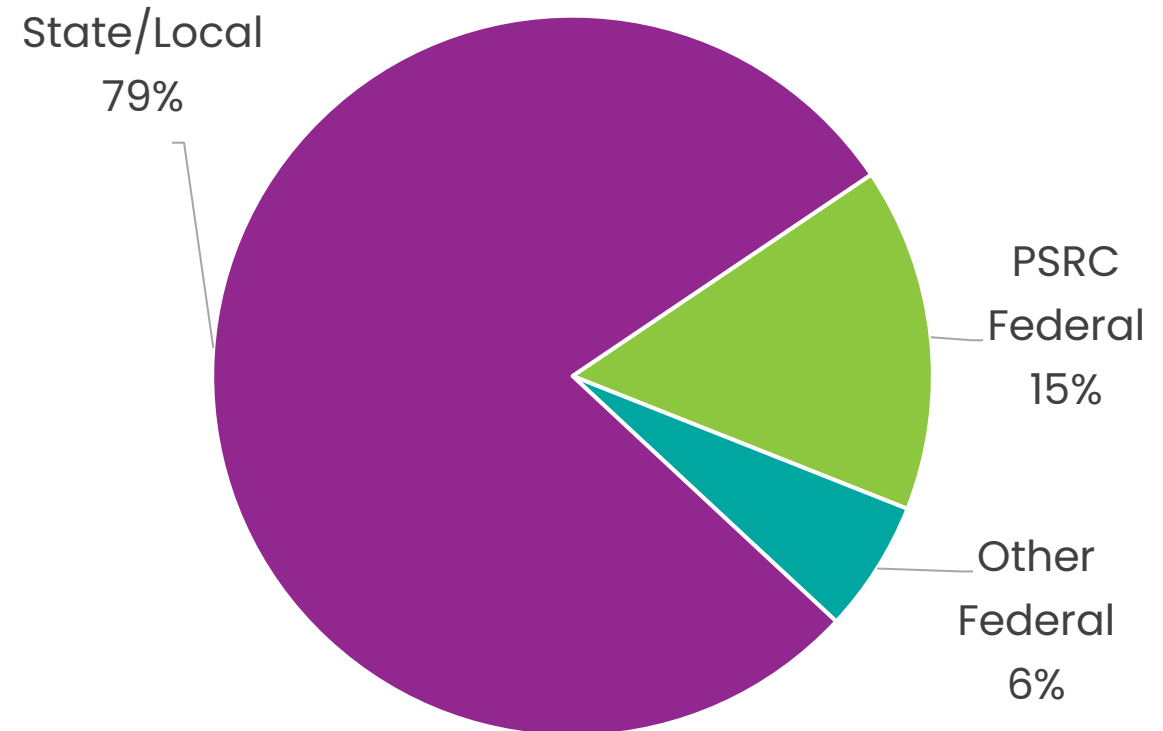

Funds by Source



Project Outcomes

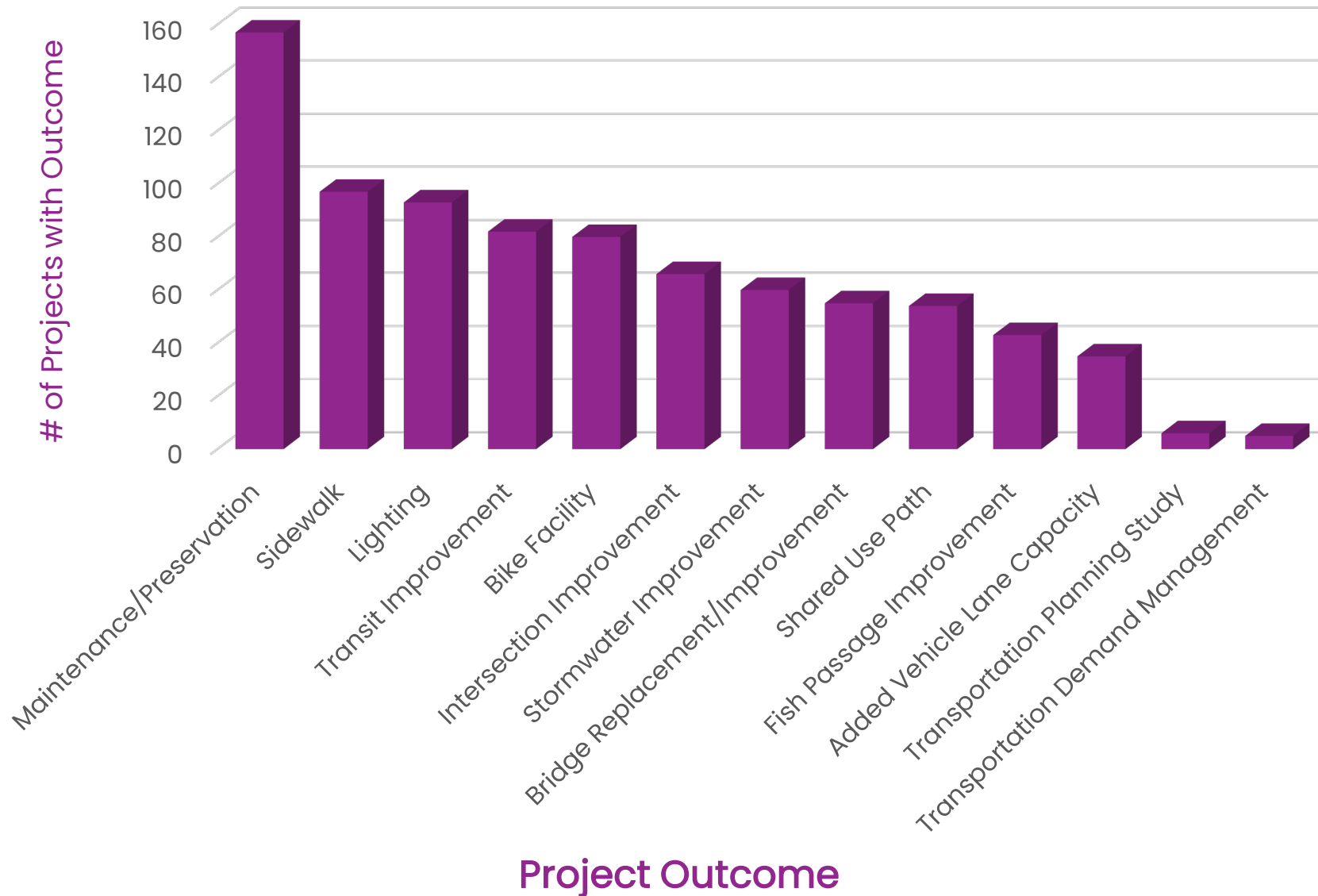

Most of the 435 projects programmed in the Draft TIP include multiple project outcomes

- *Draft TIP includes 55 Regional Capacity Projects as identified in the Regional Transportation Plan*
 - *13% of all projects*
 - *29% of all programmed funds*



Highlights of Project Outcomes



157 (36%) projects in the Regional TIP are maintenance & preservation projects, including:

- pavement overlays and reconstruction
- bridge maintenance
- transit preventative maintenance
- replacement of other assets



Highlights of Project Outcomes



Most prevalent project outcomes improve a variety of modes:

- 97 new or improved **sidewalks**
- 93 **lighting** improvements
- 82 new or improved **bike facilities**
- 80 **transit** improvement projects
- 66 **intersection projects** that include various vehicle and non-motorized improvements

202 projects located on designated freight routes

177 projects located on transit routes



Highlights of Project Outcomes



Transit projects include:

- Expansion of the region's high-capacity transit network
- Access improvements at transit stations
- Conversion to zero-emissions vehicles



Highlights of Project Outcomes

- 60 projects include stormwater improvement
- 43 state projects removing fish barriers
- Also include transportation demand management (TDM), Intelligent Transportation Systems (ITS), vehicle electrification, and safety studies



Source: Washington State Department of Transportation



Safety Countermeasures in TIP Projects

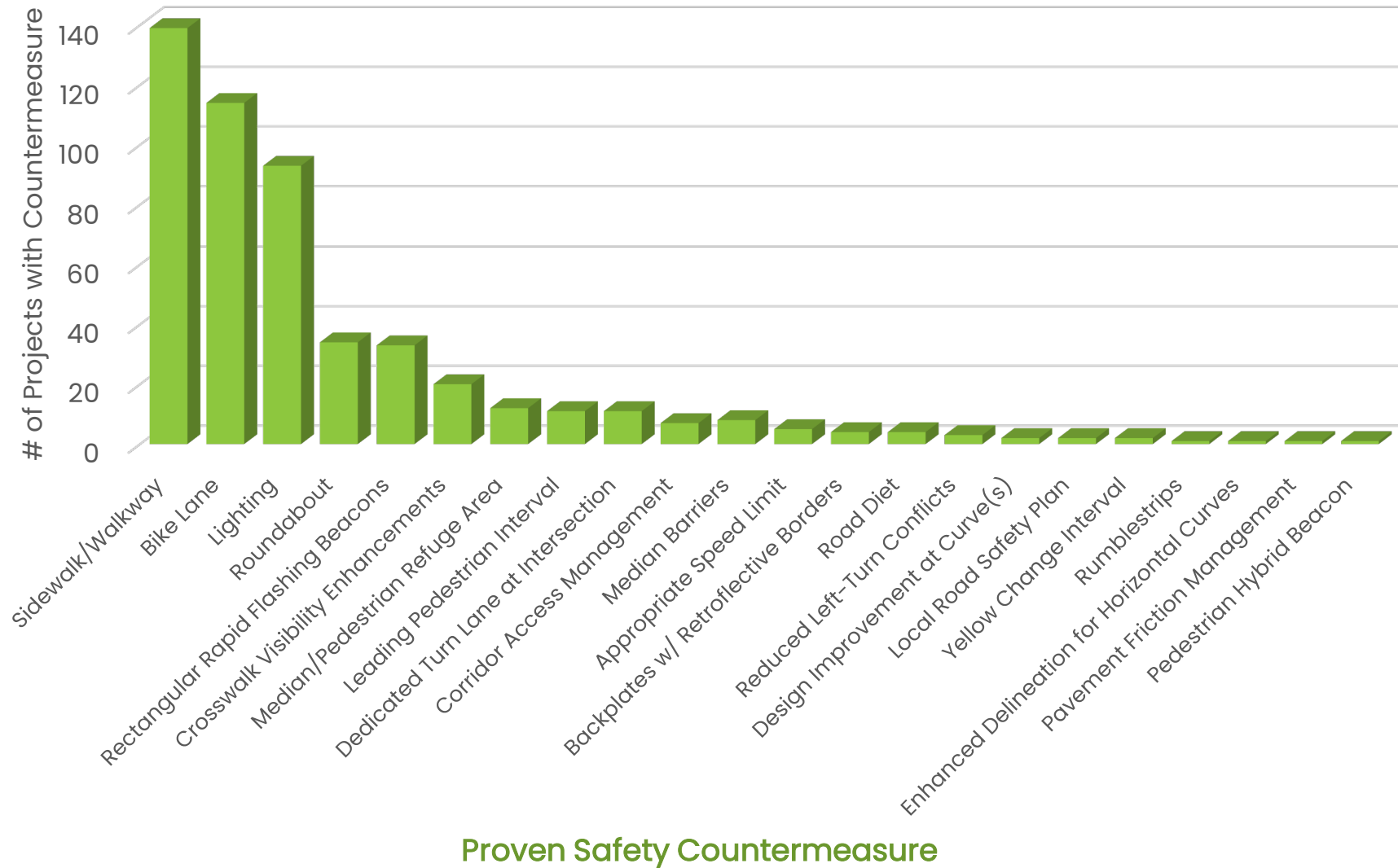

Of applicable projects:

- 75% include 2 or more safety countermeasures
- 53% include 3 or more
- 15% include 5 or more

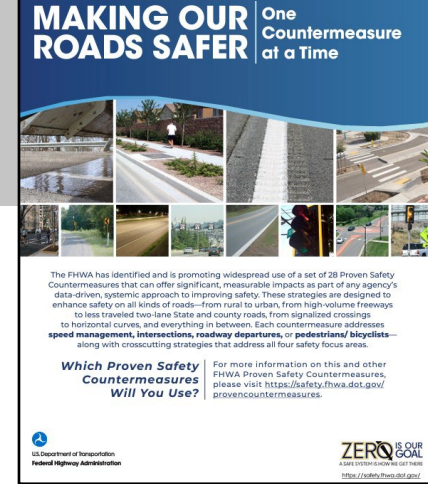

Available Information on the Draft TIP

- Summary and background information
- Interactive web map with project details
- Response to federal performance targets
- Appendices

www.psrc.org/our-work/funding/transportation-improvement-program



Overview of the Draft 2025-2028 Regional TIP

Appendix A – Projects in the Draft 2025-2028 Regional TIP

Project Map

Appendix B – 2024 Project Selection Process

Appendix C – Public Comments

Appendix D – Financial Plan

Appendix E – Air Quality Conformity Analysis

Appendix F – Equity Analysis

Appendix G – Annual Obligations and Completions

Appendix H – Certifications

Appendix I – Approvals



Project Web Map

Draft 2025-2028 PSRC Regional TIP Map

View Map

User Guide

View Full Project List

Contact Us

Select by Project

☐ (BON-18) Bonney Lake - Veterans Memorial Drive at Angeline Road Intersection

Reset

Select all

Filter by Project Type

☐ Multimodal

Reset

Select all

Filter by Sponsor(s)

No category selected

Bonney Lake - Veterans Memorial Drive at Angeline Road Intersection

Zoom to

Pan

TIP ID	BON-18
Sponsor	Bonney Lake
Title	Veterans Memorial Drive at Angeline Road Intersection
Description	Construct a roundabout at the intersection of Veterans Memorial Drive and Angeline Road with a pedestrian crossing and sidewalks on the south corner of the intersection connecting to the Fennel Creek Trail. Construct a sidewalk from Locust Avenue to the
Estimated Completion Year	2027
Project Type	Multimodal
Total Project Cost (\$)	6,000,000

Bonney Lake - Veterans Memorial Drive at Angeline Road Intersection

TIP ID	BON-18
Sponsor	Bonney Lake
Title	Veterans Memorial Drive at Angeline Road Intersection
Description	Construct a roundabout at the intersection of Veterans Memorial Drive and Angeline Road with a pedestrian crossing and sidewalks on the south corner of the intersection connecting to the Fennel Creek Trail. Construct a sidewalk from Locust Avenue to the
Estimated	2027

Draft TIP Projects

Preservation

Multimodal

Bicycle / Pedestrian

Other

Transit

Highway

ITS

12

Draft 2025–2028 TIP Public Comment and Next Steps



How to comment (September 12 – October 14)

- Online form
- Email tipcomment@psrc.org
- In person at October board meetings

www.psrc.org/our-work/funding/transportation-improvement-program



PSRC's 2024 Project Selection Process



- Project Selection Process Overview
- Project Outcomes and Highlights
- Next Steps



Project Selection Overview

Every two years, PSRC distributes federal transportation funds through four processes:

Federal Transit Administration (FTA)

Earned Share Distribution

Equity Formula Distribution

Federal Highway Administration (FHWA)

Regional Competition

Four Countywide
Competitions



Project Selection Overview

Guided by the **Policy Framework for PSRC's Federal Funds**

- Based on VISION 2050 policies
- Provides Board direction for project selection
- Provides detailed policies and procedures for conducting FTA and FHWA processes
- Adopted in January 2024
 - *Extensive board engagement September through December 2023*



Project Selection Overview

FTA processes include:

- **Earned Share Distribution**, based on actual service and operations
 - Applied to three Urbanized Areas (UZA) – Bremerton, Marysville, and Seattle-Tacoma-Everett
- **Equity Distribution**, supports Equity Focus Areas through improved transit services and access
 - Applied within the Seattle-Tacoma-Everett UZA (14% of total)



Project Selection Overview

FHWA competitive evaluation criteria address:

- Support for Centers
 - Regional competition focuses on regional growth and manufacturing / industrial centers
 - Countywide competitions focus on regional and locally designated centers
 - Mobility and Accessibility
 - Equity
 - Safety
 - Air Quality / Climate Change
- Significantly strengthened in 2024*



Project Selection Overview

2024 process distributed 2027–2028 FHWA & FTA funding

- 136 projects recommended for total of ~\$720 million

FTA	FHWA
Earned Share Distribution ~\$409 million	Regional Competition ~\$96 million
Equity Formula Distribution ~\$64 million	Four Countywide Competitions ~\$143 million



FTA Funding Recommendations



Earned Share projects include:

- Vehicle purchases
- Passenger amenities
- Fast Ferry docking facility
- Transit infrastructure (e.g., trolley poles/switches)
- Vehicle and transit facility maintenance



FTA Funding Recommendations

Equity Formula projects include:

- Americans with Disabilities Act (ADA) improvements to ferry facilities
- Equity-focused bus stop rehabilitation
- Vehicle and transit facility maintenance
- Vehicle purchases
- RapidRide expansion



Outcomes of Recommended FHWA Projects

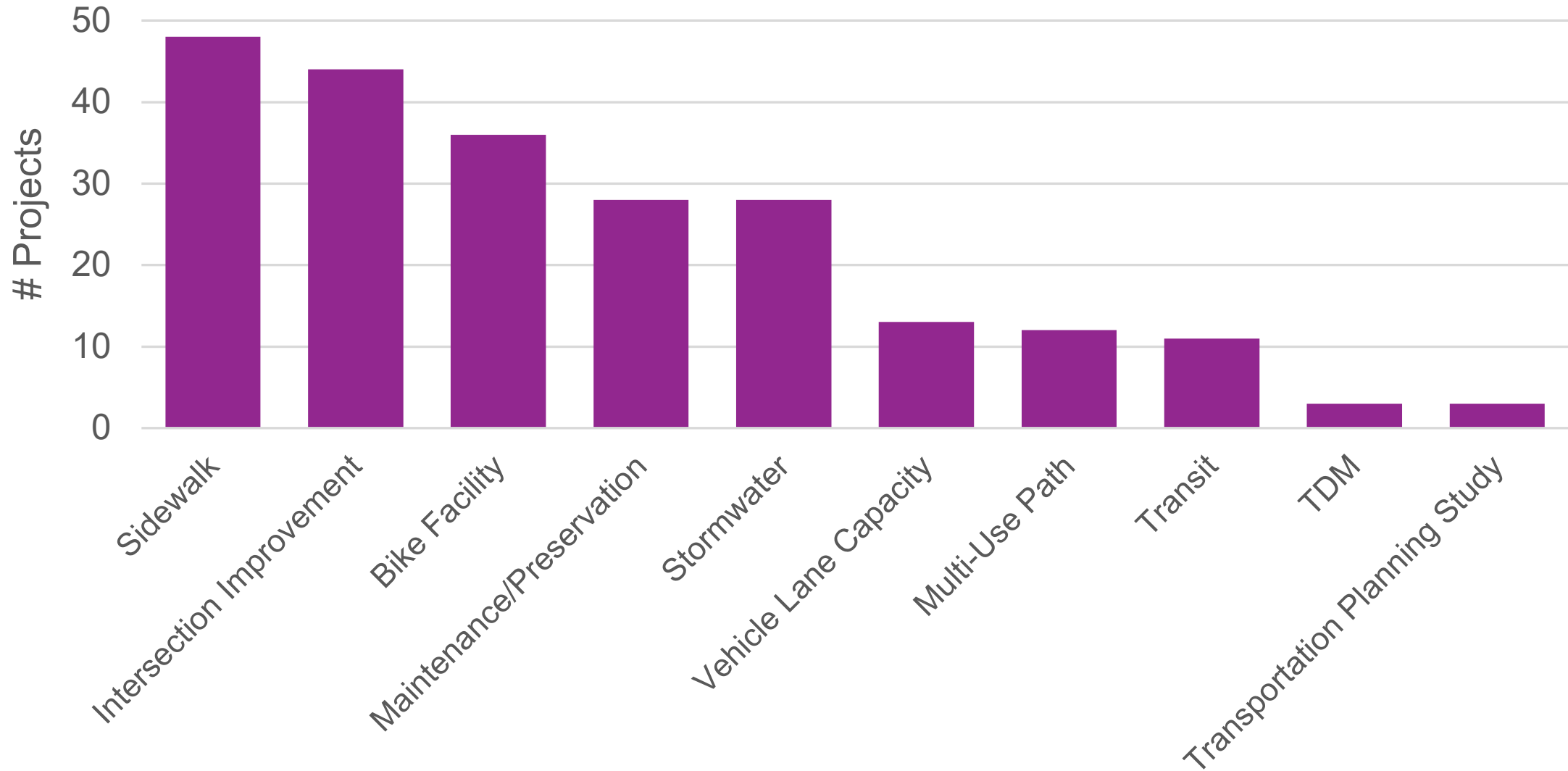

FHWA Project Outcomes – Transit

Projects include:

- Expanding High-Capacity Transit
- Transit access improvements
- Zero-Emission vehicle purchases
- Security Upgrades

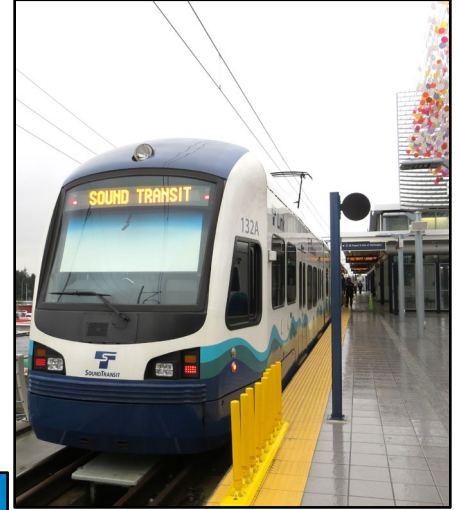

Source: Community Transit



FHWA Project Outcomes – Freight

Projects include:

- Maintenance / preservation along dedicated freight routes
- Improving flow / reducing conflicts along dedicated freight routes
- Connecting to MICs / port facilities



Source: City of Fife



FHWA Project Outcomes – Pedestrian & Bicycle

Projects include:

- New walkways
- Buffered bicycle lanes
- Improving safe crossings

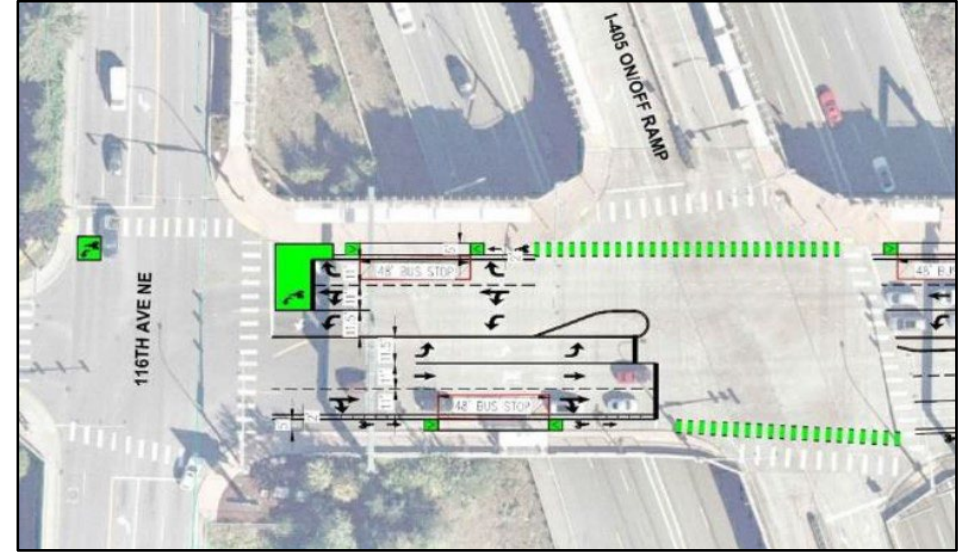

Source: City of Kirkland



Source: FHWA



Climate Highlights

Projects supporting emission reductions:

- Eliminate trips or shift away from single occupant vehicles;
- Reduce vehicle miles traveled;
- Improve traffic flow, particularly for freight vehicles;
- Convert to cleaner vehicles

Examples of recommended projects:

- *Transit expansions*
- *Transportation demand management*
- *Zero emission vehicles*
- *Pedestrian and bicycle facilities*
- *Signalization and intersection improvements*



Safety Highlights

Safety Criteria strengthened in 2024:

- Updated safety criteria & language to more concretely tie to the Safe System Approach and FHWA proven safety countermeasures
- Incorporated a commitment to working towards planning and implementation actions under a Safe System Approach
- Increased weight of safety criteria



Source: USDOT



Safety Highlights

FHWA Proven Safety Countermeasures

- Wide selection included in recommended projects
 - All applicable projects include at least one; 70% include three or more; 20% include five or more
- Ped/Bike countermeasures most common
 - Walkways, bike lanes, crossing improvements
- Reduced left-turn conflict treatments also prominently featured
 - Dedicated turn lanes, roundabouts



Equity Highlights

From the Equity Pilot and recommended by PSRC's Equity Advisory Committee:

- Equity considerations woven throughout all criteria
- Addressing the **existing disparities** for PSRC's six Equity Focus Areas (EFAs) and most marginalized
- Describing the public **outreach** process reflected in PSRC's **Equitable Engagement Guidance**
- Identifying **anti-displacement strategies** reflected in the Housing Opportunities by Place (HOP) tool



Lessons Learned and Next Steps

- Project sponsors can improve scores overall if take advantage of PSRC resources
 - *Need more sponsors to attend trainings*
- PSRC will debrief with sponsors to identify barriers and points of confusion
 - *Continue to improve guidance documents*
- Significant changes in 2024; staff recommend allowing more time for these changes to take hold
 - *Takes time for sponsors to get familiar with a process*
 - *Anticipate seeing better scores and more robust responses moving forward*



Questions?

Kelly McGourty

Director of Transportation Planning

kmcgourty@psrc.org

(206) 971-3601



Puget Sound Regional Council